

DIANA F

CAMERA

WITH FLASH ATTACHMENT

INSTRUCTION FOR USE

TAKES 16 COLOR OR BLACK/WHITE PICTURES WITH 120 FILM

INSTRUCTIONS : - FOR OPERATING DIANA-F FLASH GUN

IMPORTANT

For proper operation of flash gun—one battery must have tip up; the other, tip down. Be sure to use fresh batteries.

TO OPEN CASE—To open flash gun case for insertion of batteries, turn reflector retaining ring to left and lift out reflector.

TO INSERT BATTERIES—Use 1.5 volt Penlight Cells. (UM-3 or "AA" Size) Push batteries against battery springs and slip into place. One battery tip must be up; the other down.

TO CLOSE CASE—Replace reflector and turn reflector retaining ring to right.

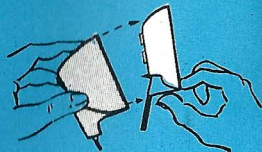

ATTACH TO CAMERA—Flash gun is installed by pushing flash gun pins into recentacles on camera.

TO INSERT FLASH BULBS—AG-1 (US-1) bulbs must be inserted directly into the flash socket with a slight push.

DO NOT TWIST THE FLASH BULB.

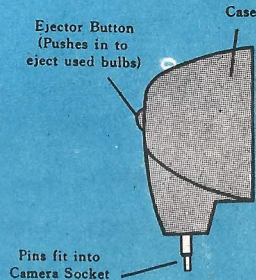
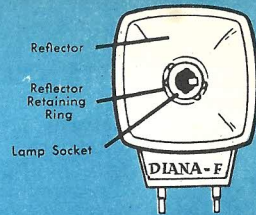

You can take 16 Colour or Black/White pictures, size $4\frac{1}{2} \times 4\frac{1}{2}$ cm, on one roll of No. 120 film. The picture on the right shows you the actual size and it can be enlarged if you so wish.

It is advisable to take color pictures in sunny days.

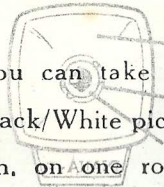

HOW TO LOAD FILM:

IT IS IMPORTANT WHEN LOADING OR UNLOADING FILM TO KEEP CAMERA AWAY FROM DIRECT LIGHT.

To open the camera turn the catch at the bottom to the word "OPEN", then pull the back cover downwards.

